



AIREYE[®]

Operation and Maintenance

CONTROLLER OPERATION

Fonctionnement du contrôleur | Funcionamiento del control | Steuerungsbetrieb

AirEye®

Secure cord retainer to plug before attaching controller to motor cable.

To turn on the fan and adjust fan speed, turn the dial to the desired speed.

Fixez le dispositif de retenue de cordon à la fiche avant de fixer le contrôleur au câble de moteur.

Pour mettre le ventilateur en marche et régler sa vitesse, tournez le cadran à la vitesse souhaitée.

Asegure el retenedor de cable al conector antes de sujetar el control al cable del motor.

Para encender el ventilador y ajustar su velocidad, gire el selector a la velocidad deseada.

Sichern Sie die Kabelhalterung am Stecker, bevor Sie die Steuerung mit dem Motorkabel verbinden.

Drehen Sie den Drehregler auf die gewünschte **Geschwindigkeit**, um den Lüfter einzuschalten und die Lüftergeschwindigkeit anzupassen.

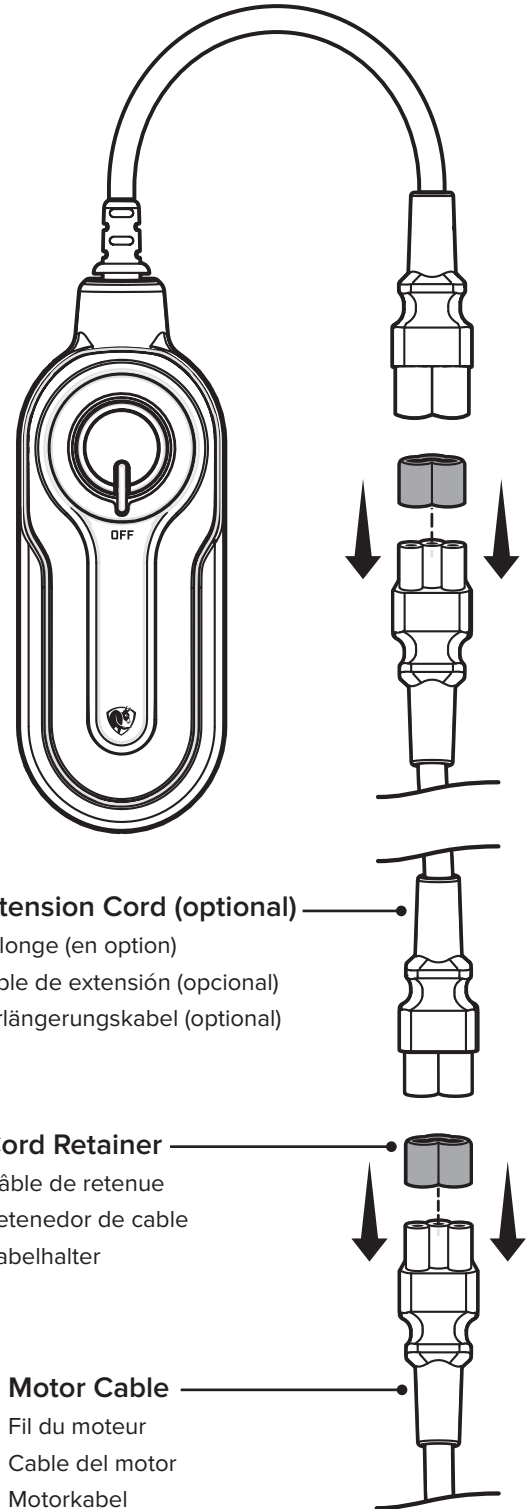

AIREYE[®] MAINTENANCE

Please take a few moments each year to perform the following preventive maintenance inspection on your fan to ensure its safe and efficient operation.

- ☑ **Clean the fan.** Remove the front cage to access the fan blade assembly. Dust the blades, cage, and motor. If desired, use a gentle cleaner or degreasing agent.

If necessary, the fan can be rinsed during cleaning. Make sure to disconnect the fan from power, remove the occupancy sensor (AEOS), and disconnect controller from motor cable. **Do not expose controller or AEOS to water.**

- ☑ **Inspect the upper safety cable for fraying or damage.** The cable should be wrapped tightly around the building structure, leaving as little slack as possible. The shackle should be securely tightened and located on the topside of the structure.
- ☑ **Inspect all fasteners, the mounting system, and the fan assembly for signs of corrosion, cracking, or fatigue/severe wear.** Replace if needed.
- ☑ **Make sure all plugs are fully seated and the cord retainers are properly installed.**
- ☑ **If ion generators are installed, inspect each ion generator for dust accumulation or damage.** Use a soft, dry cloth or compressed air to remove dust or debris.
- ☑ **Make sure all mounting bolts and nuts are present and torqued according to the table below.**
- ☑ **Make sure the set screws securing the blade assembly to the motor are torqued according to the table below and that the blade assembly retainer is secure.**

Mount/Part	Hardware	Torque
All Mounts	1/2-13 Main Mounting Bolt	30 ft·lb
All Mounts	1/4-20 Angle Adjustment Bolt	7 ft·lb
Swivel	(4) 1/2-13 x 3.5" Hex Head Cap Screws	30 ft·lb
C-Channel	(8) 3/8-16 Hex Nuts	20 ft·lb
I-Beam	(8) 3/8-16 Hex Nuts	20 ft·lb
Wall	7/16-14 x 4" Hex Head Cap Screw	30 ft·lb
Blade Assembly	(2) Allen Head or Square Head Set Screws*	150 in·lb
Rear Guard	(4) Flange Nuts	2.5 ft·lb

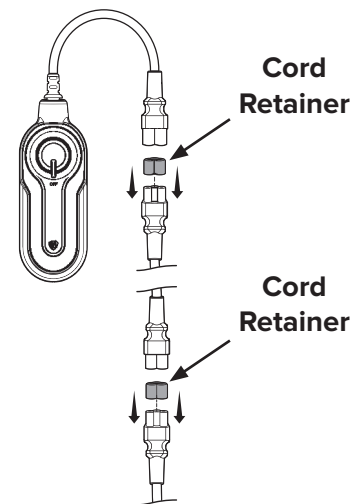

*36 in. (914 mm) fans have one set screw.

-
- ⚠ **WARNING:** Risk of fire, electric shock, or injury to persons during cleaning and user maintenance! Disconnect the appliance from the power supply before servicing.
 - ⚠ **WARNING:** When service or replacement of a component in the fan requires the removal or disconnection of a safety device, the safety device is to be reinstalled or remounted as previously installed.

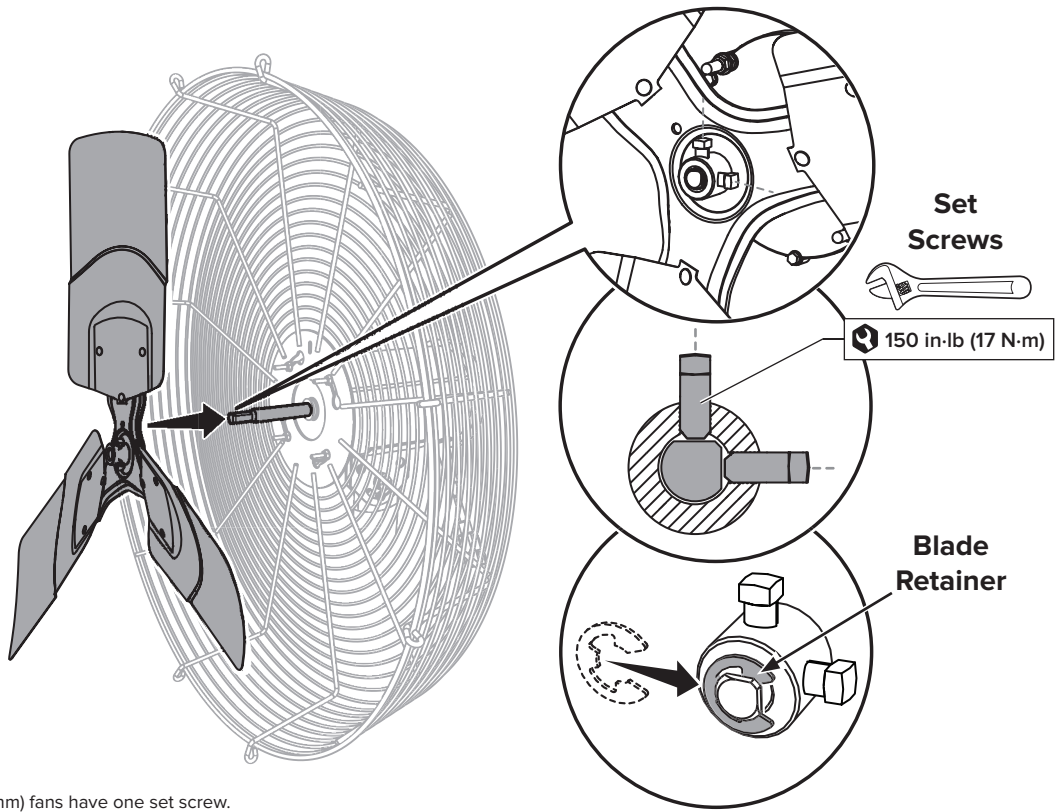

36 in. (914 mm) fans have one set screw.

OR

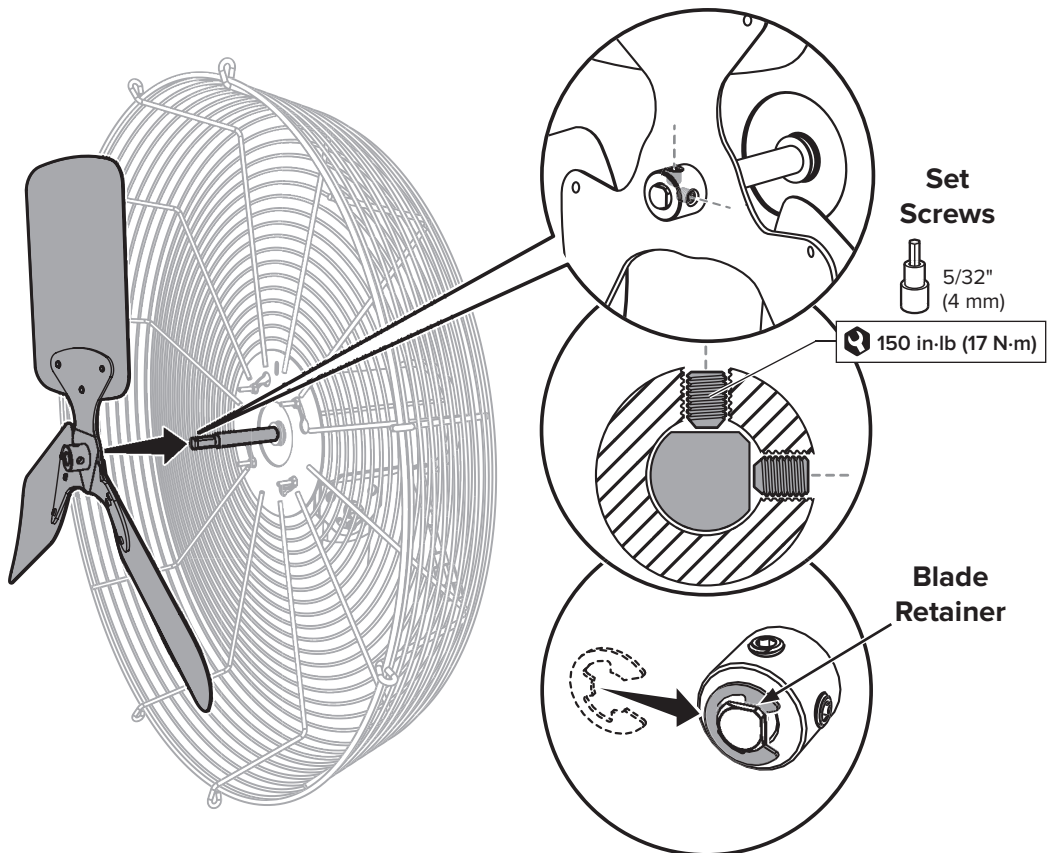

NOTES

NOTES

CONTACT US

Talk to a Big Ass Fan Expert. Call us at one of the numbers below or visit www.bigassfans.com



Customer Service

United States

2348 Innovation Drive
Lexington, KY 40511
USA
877-244-3267
Outside the U.S.
(+1 859-233-1271)
bigassfans.com

Canada

2180 Winston Park Drive
Oakville, Ontario L6H 5W1
Canada
1 844-924-4277
bigassfans.com/ca

Australia

35 French Street
Eagle Farm, Brisbane
QLD 4009
Australia
+61 1300 244 277
bigassfans.com/au

Singapore

50 Ubi Crescent
#01-01 Ubi TechPark
Singapore 408568
+65 6709 8500
bigassfans.com/sg

Mexico

CEBSA (Corporación Eléctrica
del Bravo SA de CV)
Avenida Ind. Rio San Juan
Lote 3-A Parque Industrial del Norte
Reynosa, Tamps C.P. 88736
+52 1 899 925 6398
<http://cebsainc.com/>

All Other Geographies

+1 859-410-6286
bigassfans.com



Manufacturing and Warranty

You are responsible for providing and paying for shipping when returning a product to Big Ass Fans for the purpose of recycling under the WEEE directive.

Manufacturer



2348 Innovation Drive
Lexington, KY 40511
USA

Warranty and WEEE Returns

2201 Jaggie Fox Way
Lexington, KY 40511
USA

Manufacturing Site

2251 Innovation Drive
Lexington, KY 40511
USA



BIG ASS FANS®

bigassfans.com



AIE-INST-382-ENG-01
REV. C 08/21/2023